



TIP SHEET

Home Security - 2

Doors and Frames

**Everyone's home is their castle.
You can ensure that your home remains one.**

DOOR SYSTEMS

As a home owner it is your responsibility to secure your residence to the level that you feel comfortable with. This usually starts with the basics, doors and windows. Once this is done, home owners can individualize their security needs to meet their specific requirements based on lifestyle, location and individual concerns. See Home Security Fact Sheet "Home Security Challenge".

It only takes a few seconds for a burglar to force open your front door. A kick at the right place or a solid shoulder is all that it takes. It doesn't matter if your home is new or twenty years old. The problem remains the same. This is what you need to do to reduce the likelihood of your doors being forced open. Remember that a door system is only as secure as its weakest component. You must address and reinforce all of the following:

FRAMES

1. Wood Frames (exterior door only)

(a) All exterior door frames should be set in frame openings constructed of double studding, including garage doors, but excluding overhead doors.

(b) Door frames should be installed to close tolerances (0.5 cm or 0.2 inches) inside the rough opening. An alternative is filler plates* around frames at critical areas, including all locks, latches and hinges.

* Filler material should extend 30 cm (12 inches) above and below the strike plate area, and 7.5 cm (3 inches) above and below the hinges. Filler material should consist of solid hardwood blocks.



COMMENT: The studding, spacing, and non-compressible filler plates add to the integrity of the frame, reduce the gap between the door frame and the wall studs (a potential pry area), and allow for a strong structure to support the required security hardware.

2. Steel Frames

(a) All exterior frames should be made of 18-gauge steel or heavier, and reinforced at the corners, hinges, and strikes.

(b) Frames should be filled with concrete and installed to close tolerances inside the rough opening.

(c) Steel frames should be anchored to the wall according to manufacturer's specifications.

(d) Wall structures supporting door frames should consist of double-studded wood or concrete/brick material. If unable to install or retrofit wood or steel frames to this standard, you can opt to use a vertical drop deadbolt lock installed as described in "Problem Doors" on Fact Sheet #3 in the Home Security series.

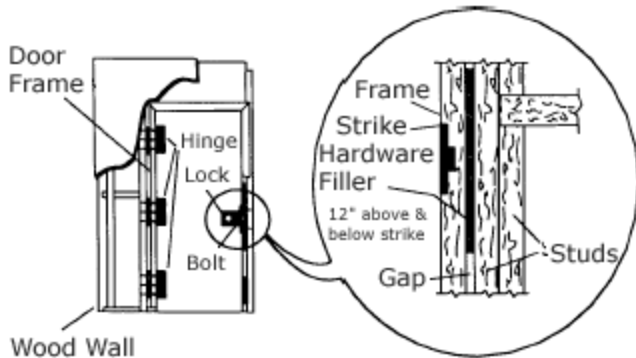



TIP SHEET

Doors and Frames - Page 2

DOORS

1. Wood

All exterior doors, including exterior and interior garage doors, should be of solid wood construction such as high density particle board, solid wood, or wood block core. No panels should exist on the doors.

2. Steel

Steel doors should be of steel grid, or steel edge construction with a minimum steel thickness of 20-gauge. Some steel doors are equipped with wood frames that are steel clad. Although these frames may offer a greater degree of protection, they should still be considered as wood frames and installed accordingly. A good starting point is to look for doors that meet the following standards:

(a) The Canadian General Standards Board's specification for wood flush doors (CAN/CDSB 0132.2-M).

(b) The Canadian General Standards Board's specification for insulated steel doors (CAN/CDSB 82.5-M).

3. Overhead Garage Doors

Overhead garage doors should be constructed of solid materials such as steel or solid wood. Caution should be used with heavy wood doors that have decorative plywood panels which can easily be kicked in. The door should fit tightly to the frame when closed.

4. Glass Area In and Around Doors

Important note. The installation of glass in or around doors within 40 inches of a lock will allow a burglar to break it and reach in to undo the lock. To counter this type of entry, many lock specialists will recommend the use of a double cylinder deadbolt lock. This type of lock has a key on the inside of the door that can be removed. Due to exit requirements in an emergency situation such as a fire, the O.P.P. **DO NOT RECOMMEND** the use of double cylinder deadbolt locks!

5. Steel Frame Installation

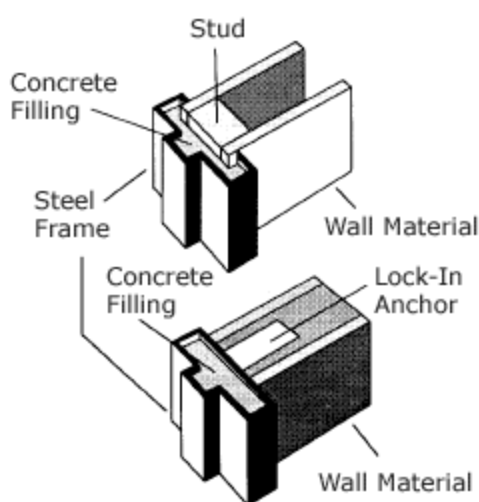

If glass is required within 40 inches of a deadbolt lock, the glass itself should be made of a security glazing product. Once the door/frame is installed securely it is time to address the security hardware requirements. Please refer to **Home Security Fact Sheet #3 "Security Hardware"**.